

# SERVICE BULLETIN

NO. 194 **Revised**

DATE: 12/04/02



180 Kehoe Boulevard • P.O. Box 8770 • Carol Stream, IL • USA 60188  
PH: 630.784.1000 • TF 877-392-7854 • FAX: 630.784.1655 [www.ajantunes.com](http://www.ajantunes.com)

---

**SUBJECT: LUBRICANT FOR VCT-2000 (HIGH TEMPERATURE) TOASTER  
BEARING NOISE  
(PART NUMBER 7000347)**

We are introducing a Lubricant for the **VCT-2000 High Temperature** Rapid Toaster Bearings that Squeak. This is a "FOOD GRADE SILICONE LUBRICANT" that meets FDA requirements and is USDA H-1 Rated. It will be a liquid in a non-aerosol spray can.

This is how the program will work:

- 1) If you receive a call regarding a squeaking toaster from December 16, 2002 through March 31, 2003 you should refer them to A.J. Antunes 1-800-253-2991 (Customer Service) or 1-877-392-7854 (Technical Service).
- 2) We will send a can of Lubricant to the restaurant at no charge through March 31<sup>st</sup>.
- 3) After March 31, 2003 we will refer the calls to you.
- 4) The Lubricant will be available for \$16.90 Suggested List Price. Since these are being sold to chain customers, they will be looking for a discount.
- 5) We will send each ASA (2) free cans of Lubricant Part Number 7000347 and free ground shipment. If you repair a toaster for another reason, you can use this to spray the bearings if squeaking.

**Replacement of noisy bearings or the application of lubrication to noisy bearings on Rapid toasters is not covered under warranty.**

Please see the enclosed Instruction sheet and MSD sheet.

### ⚠ WARNING ⚠

To avoid possible personal injury and/or damage to the unit, inspection, test and repair of electrical equipment should be performed by **QUALIFIED SERVICE PERSONNEL**. The unit should be unplugged when servicing, except when electrical tests are required. Use extreme care during electrical circuit tests. Live circuits will be exposed.

### ⚠ WARNING ⚠

Turn the unit off, disconnect the power source and allow the unit to cool down before performing any service or maintenance on the unit.

### General

If you experience any problems with these instructions, contact the factory Technical Service Department at 630-784-1000 or toll free in the U.S. at 877-392-7854.

### AFFECTED PRODUCTS

All A.J. Antunes Vertical Contact Toasters.

### REPLACING BEARINGS AND RETAINERS

#### TOOLS REQUIRED

- 5/16" nut driver
- Phillips head screw driver
- Needle-nose pliers
- Flat head screw driver
- Scotch Brite/Emory cloth
- Wire snips/wire cutter

#### INSTALLING THE REPLACEMENT BEARINGS

1. When the unit is powered off, unplugged, and cool enough to handle, remove the Compression Control knobs by pulling towards you and set knobs aside (Figures 1 and 2).
2. Remove the Bun Feeder (if equipped) and the Heat Shield (if equipped). Then, remove both Control and End covers on both sides of the unit and set both covers and hardware aside (Figures 1 and 2).
3. Using the 5/16" nut driver, remove all keps nuts securing the Bearing Retainers (**except** the two bottom Retainers on the motor side) and discard both the keps nuts and old retainers.
4. Remove all six (6) Teflon Bearings and discard. Using Scotch Brite/Emory cloth, clean the section of the shaft that comes into contact with the bearing.
5. Install new Bearings and Retainers. Secure with new keps nuts and tighten with nut driver. Do **NOT** overtighten.

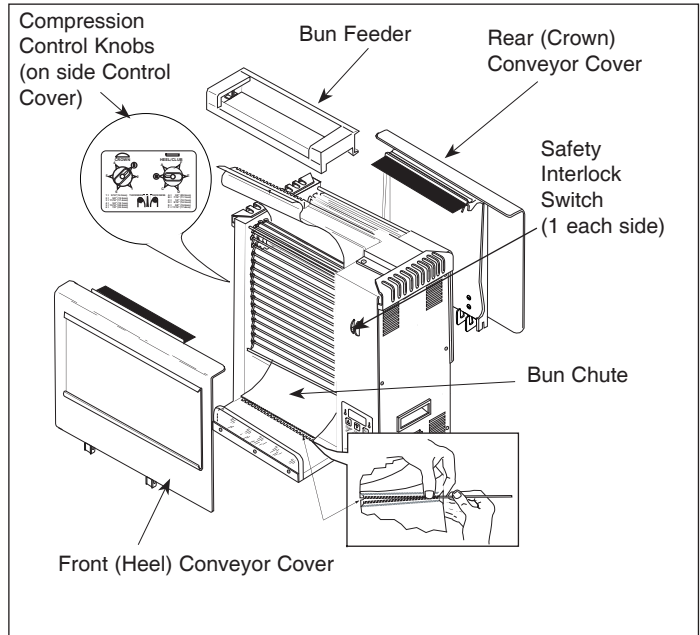

Figure 1. Component Identification  
(VCT-200/250 Only)

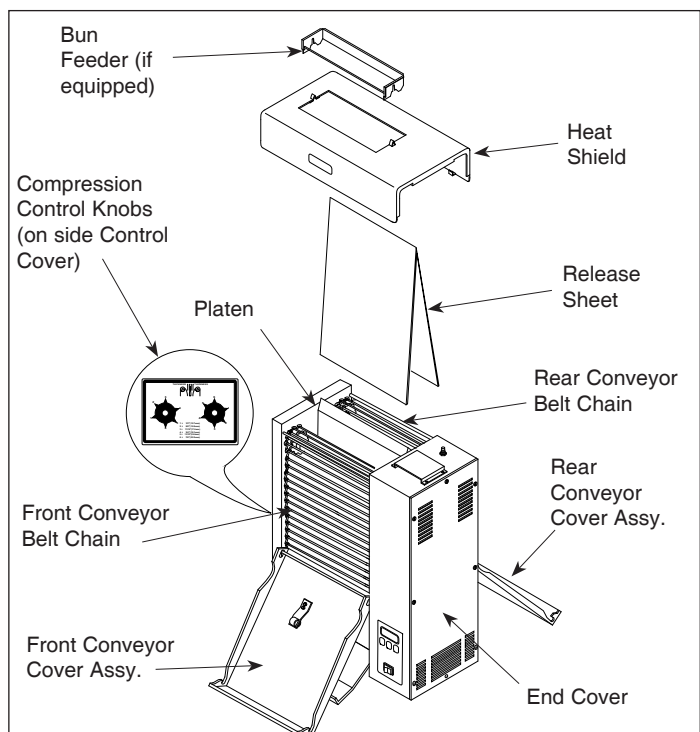

Figure 2. Component Identification  
(all other toasters)

6. Reinstall both covers and Compression Knobs and reset the Control Knobs to their correct Settings.

**REPLACING SLIDE RAILS/SLIDE BARS**

1. Open the front Conveyor Cover (Figure 1 and 2).
2. Remove Belt Wrap (if equipped) and set aside.
3. Remove the Conveyor Belt Chain (Needle-nose pliers may be required).
4. Loosen (do NOT remove) the two (2) screws of Both front Tensioner Bracket Retainers (Figure 5 on page 3).
5. Push Tensioner Bracket Retainers toward each end so the complete Tensioner Assembly can be removed.
6. Remove existing acorn nut, screw, and washer and discard both white Teflon Slide Rails and all old hardware.
7. Install the two (2) new Green Slide Rails with existing hardware. Using wire snips or wire cutters, trim the Slide Rail so it is even with the bottom of the Tensioner Plate (**on VCT-200/250 toasters only**)  
**Make sure the Slide Rails are straight.**
8. Re-install front Tensioner Assemblies. Push both Tensioner Bracket Retainers back to original position and re-tighten screws.

**NOTE:** Make sure that the Acorn Nuts securing the Slide Rail do not come into contact with the upper shaft. If there is contact, reform the bracket. Make sure this reforming does not prevent the conveyor from turning.

9. Repeat previous steps 1 through 8 for both Rear Tensioners.
10. Replace all four existing Slide Bars and discard (including old hardware).
11. Re-install Conveyor Belt Chain (needle-nose pliers may be needed) and check the measurement.

**MEASURING CONVEYOR BELT CHAINS**

Set the Compression Control Knobs to their maximum settings. For VCT-200/250 units, set the knobs to “6 & F.” For all other toasters, set the Compression Control Knobs to “6 & 6.”

Facing the toaster, locate the approximate centerpoint of the Conveyor Chain. Pull the Conveyor chain away from the edge of the toaster. Stand a U.S. Dime, 11/16” (1.8 cm) coin on end between the frame and the chain. If the gap is significantly wider than the coin, REMOVE link(s) as described below. Then, measure the gap again to make sure it is not too tight. Check the opposite side of the toaster using the same measurements (Figure 3).

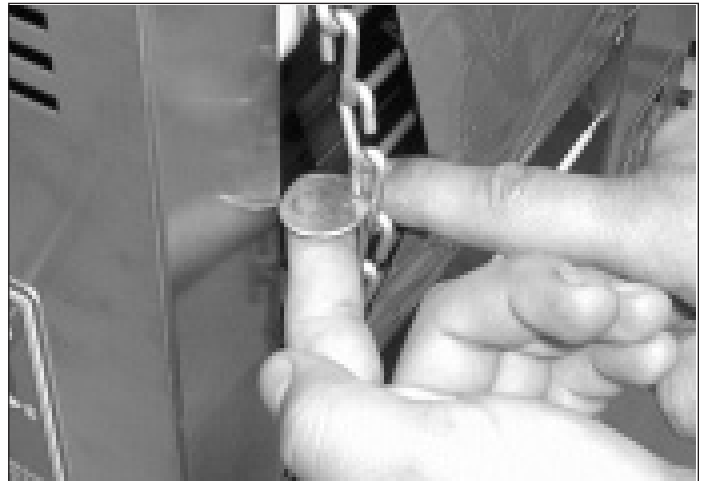

**Figure 3. Measuring Conveyor Belt Chains**

**NOTE: For VCT-200 and 250 toasters ONLY, use a U.S. Quarter coin (15/16” - 2.5 cm) for the front Conveyor Belt Chain instead of a U.S. Dime coin.**

**ADJUSTING CONVEYOR BELT CHAINS**

If the Conveyor Belt Chain is stretched, then remove one or more conveyor links. There are two 1/2" small links on each side of the conveyor belt. The rest of the links are large, 3/4" wide. Retest with coin.

13. Re-install both Conveyor Belt Wraps (if equipped).
14. Close both Front and Rear Conveyor Covers.
15. Reset the Compression Control Knobs to their original settings.
16. Connect the power cord to the appropriate power outlet.

**⚠ CAUTION ⚠**  
**Loose or over tightened conveyor chains can damage the toaster.**

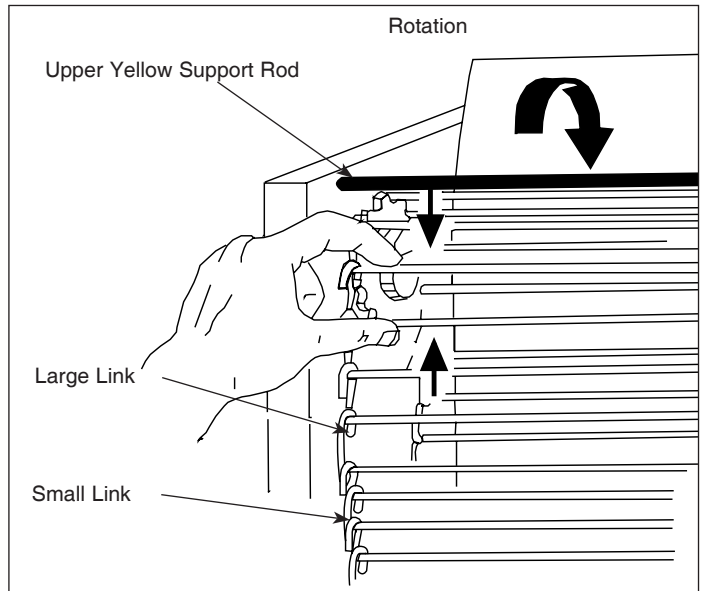

**Figure 4. Removing/Adjusting Conveyor Belt Chain Links**

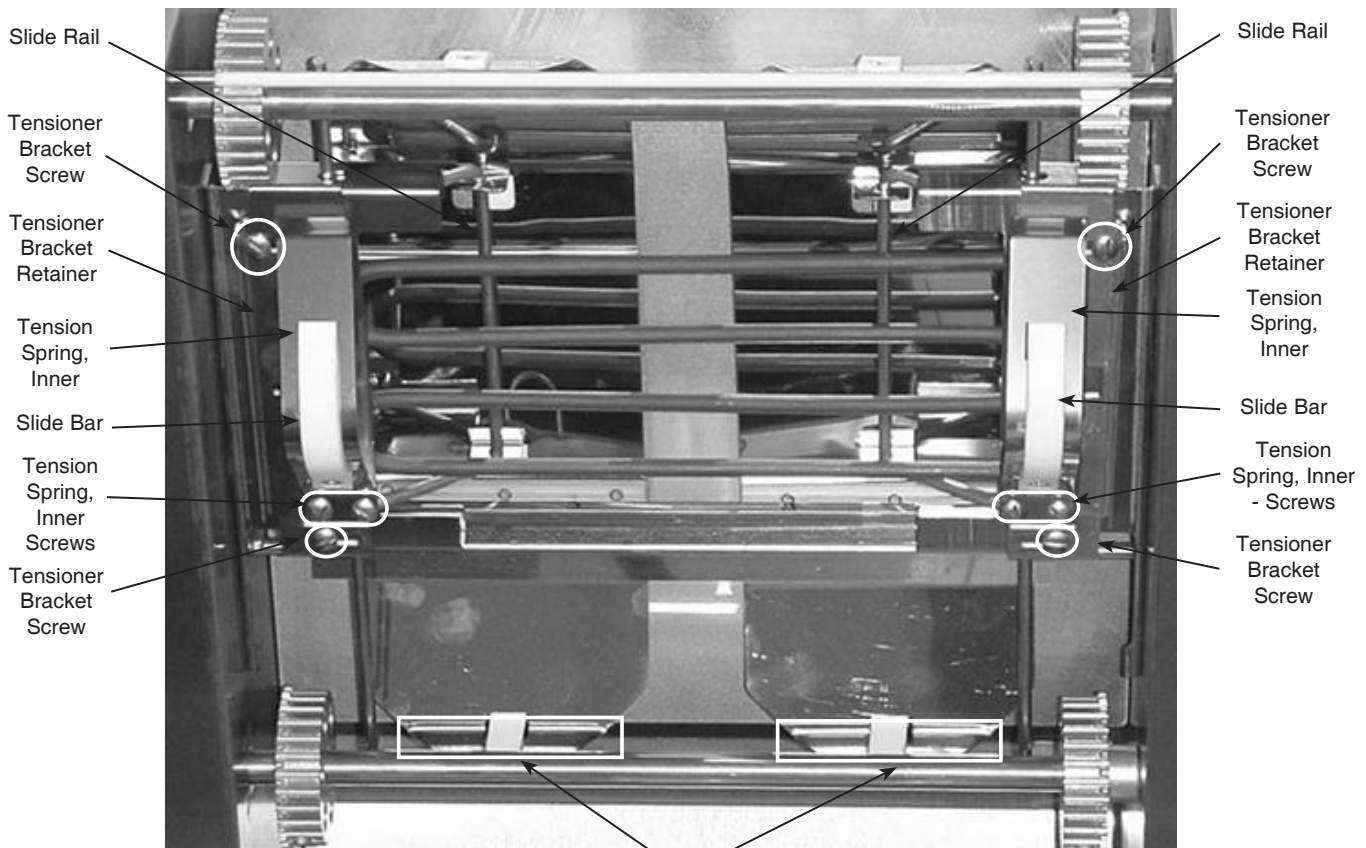

For VCT-200/250 toasters **ONLY**, trim evenly according to step 7 on page two.

**Figure 5. Interior Component Identification**

MATERIAL SAFETY DATA SHEET

210LQ  
01 00

=====  
Section 1 -- PRODUCT AND COMPANY IDENTIFICATION  
=====

PRODUCT NUMBER

210LQ

HMIS CODES

Health	1
Flammability	2
Reactivity	0

PRODUCT NAME

LIQUI-SOL\* Food Grade Silicone Lube

MANUFACTURER'S NAME

THE SHERWIN-WILLIAMS COMPANY  
Diversified Brands  
Cleveland, OH 44115

EMERGENCY TELEPHONE NO.  
(216) 566-2917

DATE OF PREPARATION

06-NOV-02

INFORMATION TELEPHONE NO.  
(800) 832-2541

=====  
Section 2 -- COMPOSITION/INFORMATION ON INGREDIENTS  
=====

% by WT	CAS No.	INGREDIENT	UNITS	VAPOR PRESSURE
94	142-82-5	Heptane		
		ACGIH TLV	400 ppm	50 mm
		ACGIH TLV	500 ppm STEL	
		OSHA PEL	400 ppm	
		OSHA PEL	500 ppm STEL	

=====  
Section 3 -- HAZARDS IDENTIFICATION  
=====

ROUTES OF EXPOSURE

Exposure may be by INHALATION and/or SKIN or EYE contact, depending on conditions of use. To minimize exposure, follow recommendations for proper use, ventilation, and personal protective equipment.

EFFECTS OF OVEREXPOSURE

Irritation of eyes, skin and upper respiratory system.

May cause nervous system depression. Extreme overexposure may result in unconsciousness and possibly death.

SIGNS AND SYMPTOMS OF OVEREXPOSURE

Headache, dizziness, nausea, and loss of coordination are indications of excessive exposure to vapors or spray mists.

Redness and itching or burning sensation may indicate eye or excessive skin exposure.

MEDICAL CONDITIONS AGGRAVATED BY EXPOSURE

None generally recognized.

CANCER INFORMATION

For complete discussion of toxicology data refer to Section 11.

A.J. Antunes & Co. is not responsible for the accuracy of this report. For more information on this product, contact the Sherwin-Williams Company. AJA P/N 1010820 11/02

=====  
 Section 4 -- FIRST AID MEASURES  
 =====

If INHALED: If affected, remove from exposure. Restore breathing.  
 Keep warm and quiet.

If on SKIN: Wash affected area thoroughly with soap and water.  
 Remove contaminated clothing and launder before re-use.

If in EYES: Flush eyes with large amounts of water for 15 minutes.  
 Get medical attention.

If SWALLOWED: Do not induce vomiting.  
 Get medical attention immediately.

 =====  
 Section 5 -- FIRE FIGHTING MEASURES  
 =====

FLASH POINT	LEL	UEL
128 F PMCC	1.1	10.0

## FLAMMABILITY CLASSIFICATION

Combustible, Flash above 99 and below 200 F

## EXTINGUISHING MEDIA

Carbon Dioxide, Dry Chemical, Foam

## UNUSUAL FIRE AND EXPLOSION HAZARDS

Closed containers may explode when exposed to extreme heat.

Application to hot surfaces requires special precautions.

During emergency conditions overexposure to decomposition products may cause a health hazard. Symptoms may not be immediately apparent. Obtain medical attention.

## SPECIAL FIRE FIGHTING PROCEDURES

Full protective equipment including self-contained breathing apparatus should be used.

Water spray may be ineffective. If water is used, fog nozzles are preferable. Water may be used to cool closed containers to prevent pressure build-up and possible autoignition or explosion when exposed to extreme heat.

 =====  
 Section 6 -- ACCIDENTAL RELEASE MEASURES  
 =====

## STEPS TO BE TAKEN IN CASE MATERIAL IS RELEASED OR SPILLED

Remove all sources of ignition. Ventilate the area.

Remove with inert absorbent.

 =====  
 Section 7 -- HANDLING AND STORAGE  
 =====

## STORAGE CATEGORY

DOL Storage Class II

## PRECAUTIONS TO BE TAKEN IN HANDLING AND STORAGE

Contents are COMBUSTIBLE. Keep away from heat and open flame.

Consult NFPA Code. Use approved Bonding and Grounding procedures.

Keep container closed when not in use. Transfer only to approved containers with complete and appropriate labeling. Do not take internally. Keep out of the reach of children.

=====  
 Section 8 -- EXPOSURE CONTROLS/PERSONAL PROTECTION  
 =====

## PRECAUTIONS TO BE TAKEN IN USE

Use only with adequate ventilation.

Avoid contact with skin and eyes. Avoid breathing vapor and spray mist.

Wash hands after using.

## VENTILATION

Local exhaust preferable. General exhaust acceptable if the exposure to materials in Section 2 is maintained below applicable exposure limits. Refer to OSHA Standards 1910.94, 1910.107, 1910.108.

## RESPIRATORY PROTECTION

If personal exposure cannot be controlled below applicable limits by ventilation, wear a properly fitted organic vapor/particulate respirator approved by NIOSH/MSHA for protection against materials in Section 2.

## PROTECTIVE GLOVES

Wear gloves which are recommended by glove supplier for protection against materials in Section 2.

## EYE PROTECTION

Wear safety spectacles with unperforated sideshields.

## OTHER PRECAUTIONS

Intentional misuse by deliberately concentrating and inhaling the contents can be harmful or fatal.

 =====  
 Section 9 -- PHYSICAL AND CHEMICAL PROPERTIES  
 =====

PRODUCT WEIGHT	5.94 lb/gal	711 g/l
SPECIFIC GRAVITY	0.71	
BOILING POINT	198 - 212 F	92 - 100 C
MELTING POINT	Not Available	
VOLATILE VOLUME	95 %	
EVAPORATION RATE	Slower than ether	
VAPOR DENSITY	Heavier than air	
SOLUBILITY IN WATER	N.A.	
VOLATILE ORGANIC COMPOUNDS (VOC Theoretical)		
5.58 lb/gal	669 g/l	Less Federally Exempt Solvents
5.58 lb/gal	669 g/l	Emitted VOC

 =====  
 Section 10 -- STABILITY AND REACTIVITY  
 =====

STABILITY -- Stable

CONDITIONS TO AVOID

None known.

INCOMPATIBILITY

None known.

HAZARDOUS DECOMPOSITION PRODUCTS

By fire: Carbon Dioxide, Carbon Monoxide

HAZARDOUS POLYMERIZATION

Will not occur

=====  
 Section 11 -- TOXICOLOGICAL INFORMATION  
 -----

## CHRONIC HEALTH HAZARDS

No ingredient in this product is an IARC, NTP or OSHA listed carcinogen. Reports have associated repeated and prolonged overexposure to solvents with permanent brain and nervous system damage.

 -----

## TOXICOLOGY DATA

CAS No.	Ingredient Name				
142-82-5	Heptane	LC50	RAT	4HR	Not Available
		LD50	RAT		Not Available

 -----

 =====  
 Section 12 -- ECOLOGICAL INFORMATION  
 -----

## ECOTOXICOLOGICAL INFORMATION

No data available.

 -----

 =====  
 Section 13 -- DISPOSAL CONSIDERATIONS  
 -----

## WASTE DISPOSAL METHOD

Waste from this product may be hazardous as defined under the Resource Conservation and Recovery Act (RCRA) 40 CFR 261.

Waste must be tested for ignitability to determine the applicable EPA hazardous waste numbers.

Incinerate in approved facility. Do not incinerate closed container. Dispose of in accordance with Federal, State/Provincial, and Local regulations regarding pollution.

 -----

 =====  
 Section 14 -- TRANSPORT INFORMATION  
 -----

No data available.

 -----

 =====  
 Section 15 -- REGULATORY INFORMATION  
 -----

## SARA 313 (40 CFR 372.65C) SUPPLIER NOTIFICATION

CAS No.	CHEMICAL/COMPOUND	% by WT	% Element
No ingredients in this product are subject to SARA 313 (40 CFR 372.65C) Supplier Notification.			

 -----

## TSCA CERTIFICATION

All chemicals in this product are listed, or are exempt from listing, on the TSCA Inventory.

 -----

 =====  
 Section 16 -- OTHER INFORMATION  
 -----

This product has been classified in accordance with the hazard criteria of the CPR and the MSDS contains all of the information required by the CPR.

The above information pertains to this product as currently formulated, and is based on the information available at this time. Addition of reducers or other additives to this product may substantially alter the composition and hazards of the product. Since conditions of use are outside our control, we make no warranties, express or implied, and assume no liability in connection with any use of this information.