

Model: Series TCO

Antunes Controls Series TCO is an inexpensive open board temperature controller with a remote potentiometer. This unit can be mounted inside the panel and only requires a 3.88" x 3.63" area. The setpoint potentiometer and knob is then mounted through a single .367" hole. This unit consists of 3 main parts: circuit board, potentiometer with leads, hardware and overlay with range.

Features:

- Power Input: 120Vac, 230Vac, 24Vac, 12Vac (50/60 Hz)
- Control Output: S.P.D.T. Relay rated 10 Amps (resistive)
- Sensor input: J or K Thermocouple
- Setpoint ranges: 25-350°F
0-175°C, 70-150°F,
25-375°F/0-190°C
- Hysteresis: Factory set 2% of full scale (other ranges are available)
- Remote potentiometer: 1K resistive linear, 24" leads (other lead lengths available.)

Dimensions:

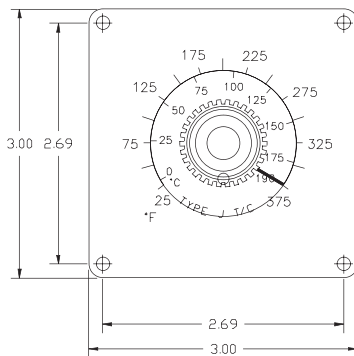
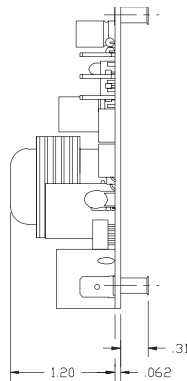
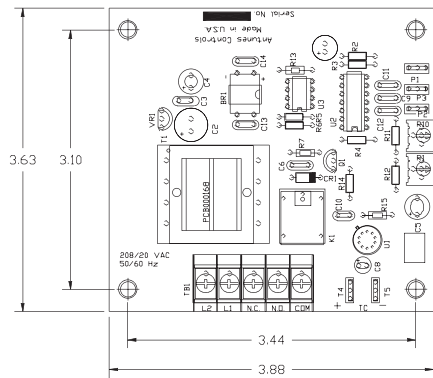

Operation:

The setpoint temperature is adjustable by turning the integral dial. The controller will regulate the relay to the chosen temperature cycling the normally closed contact. The setting variation in temperature of the controller output is determined by the hysteresis. The hysteresis setting must be specified when ordering and is not customer adjustable.

Wiring:

Carefully follow the terminal designations that are screened on the control circuit board. Be careful not to exceed the current and voltage ratings stated in the specifications. All local and national electrical codes must be followed. The input power should be placed on terminals L1 and L2. The power that is being switched to the load should be placed on either N.O. or N.C. terminal. The load should be placed on COM. Use only the sensor types as indicated and verify that the correct polarity is maintained. The red thermocouple lead always is connected to the negative (-) terminal. Potentiometer connections are: P3-CW, P1-CCW, P2-Wiper.

Maintenance:

No specific maintenance is required. However, it is recommended that all wiring be inspected for loose connections and damaged wires. Disconnect power to the panel before performing any maintenance. Replace any damaged wires and tighten all connections.

Specifications:

- Power Input:** 120Vac, 230Vac, 24Vac, 12Vac (50/60 Hz)
TBI pins L1 & L2
- Control Output:** S.P.D.T. Relay rated 10 Amps (resistive)
TBI pins N.C., N.O. & COM
- Sensor Input:** J or K Thermocouple (.187 spade terminals) TC pins "-", "+", white (J) or yellow (K)
- Setpoint Ranges:** 25-350°F/0-175°C, 70-150°F, 25-375°F/0-190°C
- Hysteresis:** Factory set 2% of full scale (other ranges are available)
- Terminals:** Wire ranges 14-22 AWG, Voltage 300V, Current 15 AMPS
- Remote Potentiometer:** 1K resistive linear, 24" leads (other lead lengths available upon request)

Limitation of Liability. If it is understood and agreed that seller's liability whether in contract, in tort, under any warranty, in negligence or otherwise, shall not exceed the return of the amount of the purchase price paid by purchaser and under no circumstances shall seller be liable for special, indirect or consequential damages. The price stated for the equipment is a consideration in limiting seller's liability. No action, regardless of form, arising out of the transactions may be brought by purchaser more than one year after the cause of action has accrued.